



HV Series



HL551



HL1553

## Range-Lite HV/HL

### Twin beam emergency lighting

A compact member of the Range-Lite family for indoor use, in smaller warehouse and factory spaces. The standard unit can be mounted upright on a wall or stanchion. If the fitting is to be orientated in any other way an optional battery retaining clamp should be ordered for security.

### SPECIFICATION

ELECTRICAL & OPERATIONAL	SELF-CONTAINED
<b>Input voltage</b>	230 – 240v 50Hz
<b>Duration</b>	3 hours (HV3 models), 1 hour (HV1 model), 1 hour (HL551)
<b>Battery</b>	HV183 – 2x 6v12Ahr, HV203 – 2 x 12v7Ahr12v sealed lead acid, 3-5 year design life
<b>Charger</b>	Temperature compensated pulse charger, short circuit, thermal & reverse polarity protection. Low voltage cut off
<b>Charging monitor</b>	LED for battery charge monitor
<b>Lamp monitor</b>	Dual filament monitor
<b>Em lamp o/p (lumens)</b>	260 (18w), 300 (20w), 900 (55w)
<b>Recharge period</b>	24 hours for full capacity

### CONSTRUCTION & INSTALLATION

<b>Cable entry</b>	20mm knockouts
<b>Construction</b>	Mild steel enclosure with removable front panel. Powder coat paint finish
<b>Dimensions whd (mm)</b>	260 x 358 x 99 (470 x 320 x 135 HL, IR2 and Centrel versions)
<b>Weight (kg)</b>	7.8 (max)
<b>Lamps HV18</b>	18w HIT fully adjustable circular polycarbonate housing in white with clear polycarbonate lens
<b>Lamps HV20</b>	20w tungsten halogen – circular plastic housing in white with clear polycarbonate lens
<b>Lamps HL55</b>	55w tungsten halogen, rectangular body in black with clear lens
<b>Lamp mounting</b>	Two positions on top of the enclosure
<b>Environment</b>	0 – 25°C (indoor use)
<b>Product standard/Approvals</b>	Designed & manufactured to meet the requirements of BS EN 60598.2.22

### TO ORDER

#### STANDARD ORDER CODE

<b>HV181</b>	Twin beam emergency lighting, 2x18w NM1, powder coated steel body, clear PC lens
<b>HV183</b>	Twin beam emergency lighting, 2x18w NM3, powder coated steel body, clear PC lens
<b>HV201</b>	Twin beam emergency lighting, 2x20w NM1, powder coated steel body, clear PC lens
<b>HV203</b>	Twin beam emergency lighting, 2x20w NM3, powder coated steel body, clear PC lens
<b>HL551</b>	Twin beam emergency lighting, 2x55w NM1, powder coated steel body, clear lens
<b>HL1553</b>	Single beam emergency lighting, 1x55w NM3, steel body, clear lens

#### OPTIONS

<b>SUFFIX TD</b>	Run on timer
------------------	--------------

#### ACCESSORIES

<b>HVBC</b>	Battery retaining clamp (HV versions)
<b>HLWG</b>	Wire guard (indoor versions)

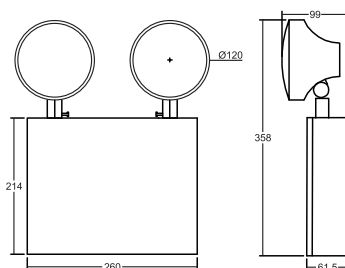

HV Series

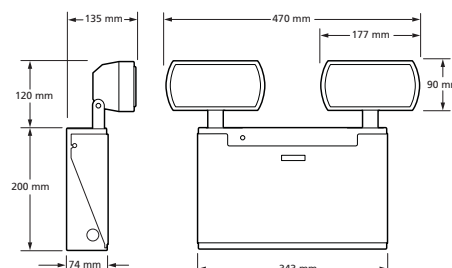

IR2 and CT models (HL551 with rectangular lamps, other models circular lamps)



## Range-Lite HL/E3

### Twin beam emergency lighting

Twin beam Range-Lites, rated for external use with battery and electronics enclosure sealed to IP65 & the lamps mounted remotely on brackets.

### Lamp projector assembly

The lamp projector assembly allows head adjustment in the horizontal and vertical planes. The projector location on the enclosure enables head alignment to meet the anti-glare requirement. Projectors should be mounted at least 30° above the line of sight.



HL 203 E3

### SPECIFICATION

ELECTRICAL & OPERATIONAL	SELF-CONTAINED
<b>Input voltage</b>	230 – 240v 50Hz
<b>Duration</b>	3 hours (HL203E3), 1 hour (HL201E3, HL551E3)
<b>Battery</b>	12v sealed lead acid, 3-5 year design life
<b>Charger</b>	Temperature compensated pulse charger, short circuit, thermal & reverse polarity protection. Low voltage cut off
<b>Charging monitor</b>	LED for battery charge monitor
<b>Lamp monitor</b>	Dual filament monitor
<b>Recharge period</b>	24 hours

### CONSTRUCTION & INSTALLATION

<b>Cable entry</b>	20mm knockouts
<b>Construction IP65 model</b>	Polycarbonate enclosure with screw locked front panel Glanding points on sides for cable gland fixing
<b>Dimensions whd (mm) IP65 model</b>	280 x 280 x 130
<b>Weight (kg)</b>	IP65 models – 7.6 (max)
<b>Lamps – IP65 models</b>	20w or 55w halogen – rectangular case and lens in polycarbonate. Separately supplied on angle brackets, with glands for wiring to the main enclosure
<b>Environment</b>	0 – 25°C
<b>Product standard/Approvals</b>	Designed & manufactured to meet the requirements of BS EN 60598.2.22

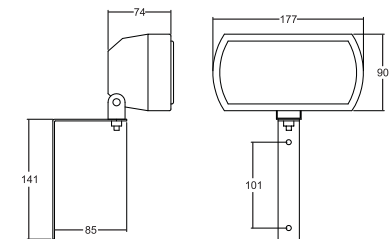
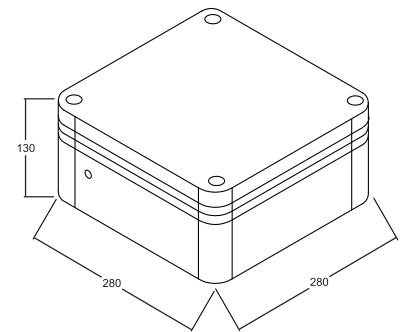

HLE3 lamp dimensions

### TO ORDER

#### STANDARD ORDER CODE

<b>HL201E3</b>	Twin beam emergency lighting, 2x20w NM1, PC body, clear PC lens, IP65
<b>HL203E3</b>	Twin beam emergency lighting, 2x20w NM3, PC body, clear PC lens, IP65
<b>HL551E3</b>	Twin beam emergency lighting, 2x55w NM1, PC body, clear PC lens, IP65

#### OPTIONS

<b>SUFFIX TD</b>	Run on timer
------------------	--------------

- For AC/AC or AC/DC slave luminaires please refer to our EMEX Central Power Supply Systems Catalogue.

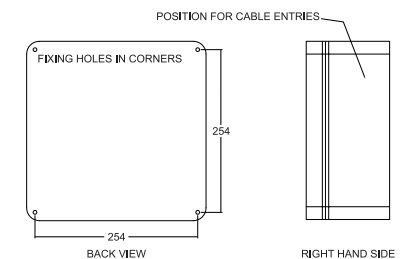

LE3 Series fixings and cable entries

### SPACING DATA TABLE AT LAMP ANGLE 60° (Spacing between projectors)

Mounting height (m)	2X18W			2x20w			2x55w		
	Escape route (min. 0.2 lux)	Escape route (min. 1 lux)	Anti panic (min. 0.5 lux)	Escape route (min. 0.2 lux)	Escape route (min. 1 lux)	Anti panic (min. 0.5 lux)	Escape route (min. 0.2 lux)	Escape route (min. 1 lux)	Anti panic (min. 0.5 lux)
4.0	28.9	20.5	22.9	30.02	21.49	23.8	-	-	-
6.0	36.9	-	-	38.41	-	29.76	47.9	34.4	37.8
8.0	43.4	-	-	45.26	-	-	56.84	-	44.7

